

OTTAWA 2 DOOR WARDROBE ASSEMBLY INSTRUCTIONS

Thank you for purchasing the Ottawa 2 Door Wardrobe.
Please read the instructions carefully to ensure safe operation of this product.

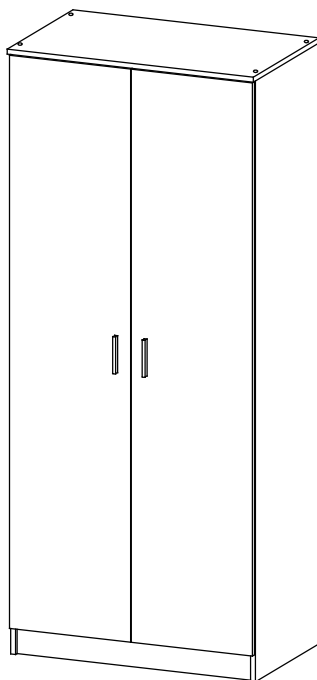

Size: 76 x 46.5 x 180.5 cm (WDH)

Colours: Gloss Black-Walnut or Gloss White-White or Gloss Black-Black
or Gloss White-Oak

Finish: Gloss Resin Painting - Melamine Carcass

PLEASE READ this sheet prior to assembly to familiarise yourself with the various stages of construction.

Carefully open the pack supplied and check the contents against the parts and fittings check list. Do not destroy any of the packaging until you are certain that you have all the necessary parts for the assembly.

CAUTION: There are small components used in the construction of this unit. These loose items should be kept away from young children whilst assembling your unit to avoid the danger of choking.

Tools Required

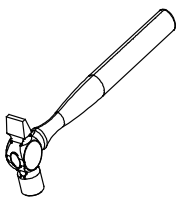
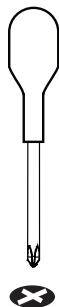
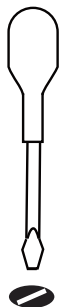

Number of people

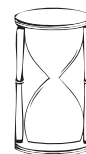

1 Hour
Set Up

Batch No. 271601

PO No : 5938

Page 1 of 12

OTTAWA 2 DOOR WARDROBE ASSEMBLY INSTRUCTIONS

IMPORTANT - READ CAREFULLY - RETAIN THESE INSTRUCTIONS FOR FUTURE REFERENCE.

INFORMATION

- This product is designed to hold 25Kg in total. Do not exceed this weight.
- We recommend that this unit is assembled in the room intended for use.
- When you are ready to start, make sure that you have the right tools, plenty of space and a clean, dry area for assembly.
- Unwrap all packaging materials and place each component on top of the carton box or on a clean floor to prevent it from scratching.
- Check the pack and make sure you have all the parts listed.
- Ensure that this product is fully assembled as illustrated before use.
- Check all screws or bolts are tightened and inspect regularly.
- Tools are not included unless specified in the parts list.

WARNINGS

- This product should only be used on a firm and level floor.
- Keep small parts out of reach of children.
- Make sure the legs/base remain in contact with the floor.
- DO NOT use power tools to construct this product.
- DO NOT tighten screws until parts are assembled or as advised in this guide:
- DO NOT over tighten screws or bolts.
- DO NOT use this product if parts are missing, damaged or worn.
- DO NOT climb, sit or stand on the product.

CARE INFORMATION

- Never use scourers, abrasives or chemical cleaners.
- To clean, wipe with a damp sponge and warm soapy water. Do not use solvent based cleaners or detergents as they can bleach or damage the product.

OTTAWA 2 DOOR WARDROBE ASSEMBLY INSTRUCTIONS

Parts and Fittings Checklist

Please check the pack contents before assembling the product. If any components are missing, please contact your retailer. The fittings pack contains small items that should be kept away from small children.

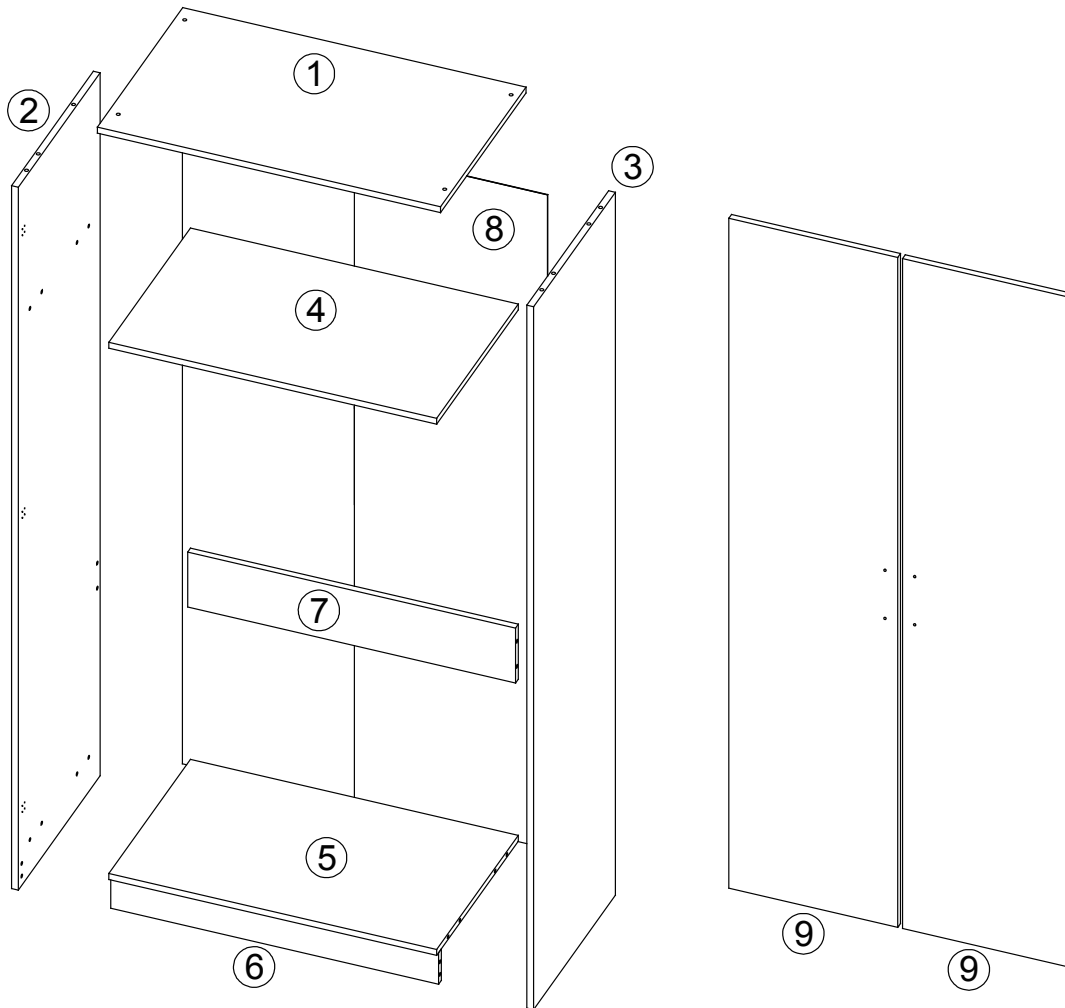

Parts are packed in one carton

1	2	3
Description: Top Panel Qty: 1 Carton No: 1/1	Description: LH Side Panel Qty: 1 Carton No: 1/1	Description: RH Side Panel Qty: 1 Carton No: 1/1
4	5	6
Description: Fixed Shelf Qty: 1 Carton No: 1/1	Description: Base Panel Qty: 1 Carton No: 1/1	Description: Plinth Qty: 1 Carton No: 1/1
7	8	9
Description: Back Rail Qty: 1 Carton No: 1/1	Description: Back Panel Qty: 1 Carton No: 1/1	Description: Door Qty: 2 Carton No: 1/1

OTTAWA 2 DOOR WARDROBE ASSEMBLY INSTRUCTIONS

Fittings (to scale)

Code	Item	Quantity
A	Cam Bolt (35mm overall)	18
B	Cam Lock	18
C	Dowel (8x30mm)	12
D	Carcass Screw for fitting Top Panel (M7x50mm)	4
E	Screws for fitting Hinge, Hanging Rail Support, Back Panel & Anti-tilt Wall Strap. (3.5x12.5mm)	57
F	Bolt for fitting Handle (M4x18mm)	4
G	Nail for fitting Back Panel (2x12mm)	24

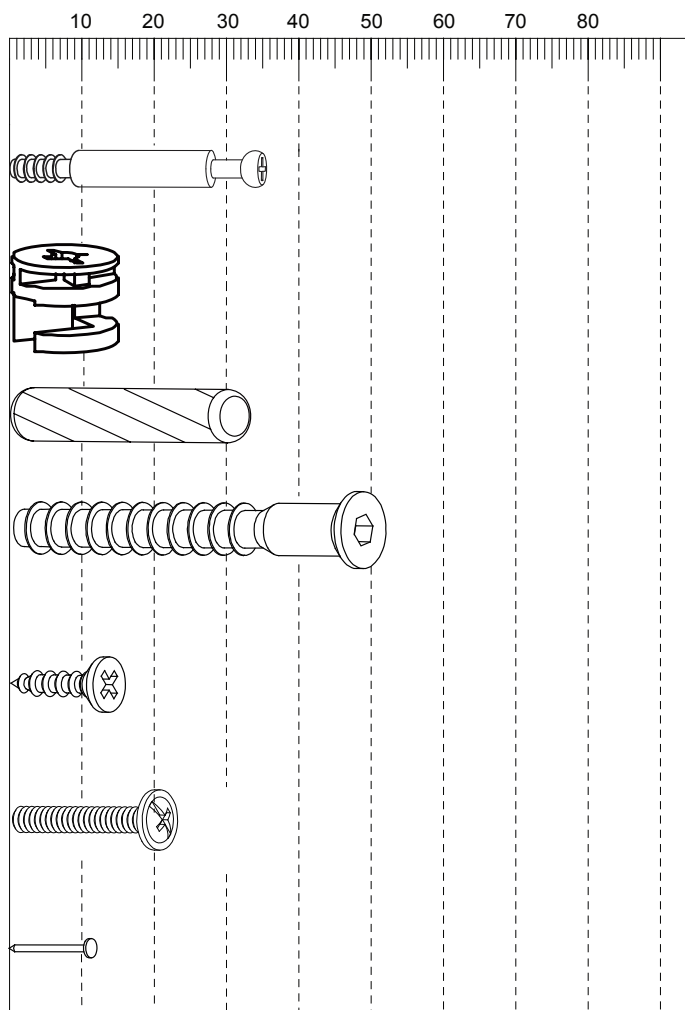

General Hints & Tips

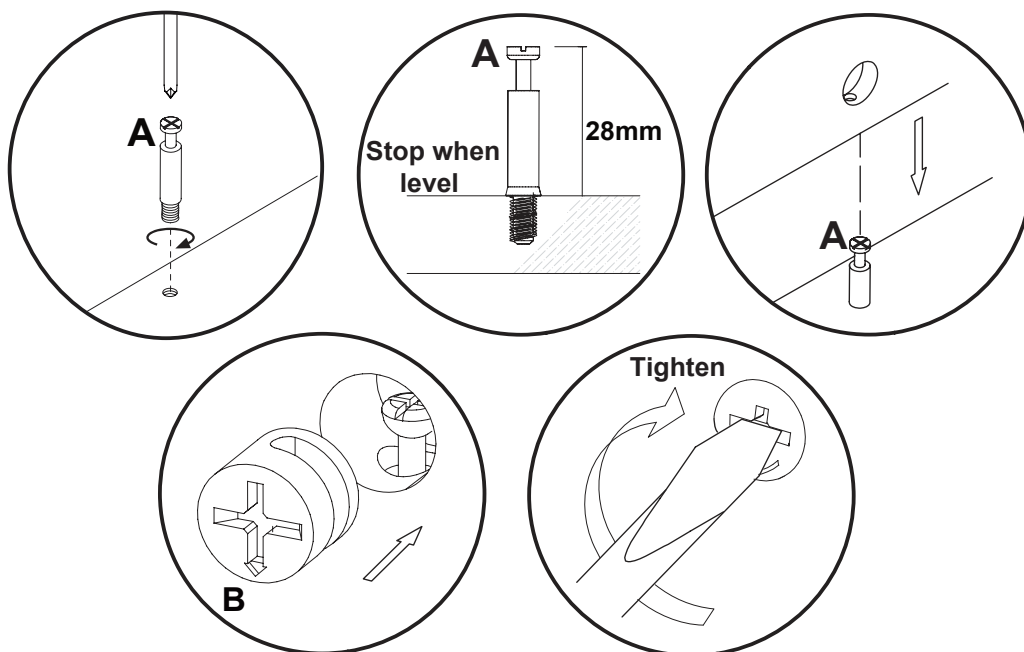

OTTAWA 2 DOOR WARDROBE ASSEMBLY INSTRUCTIONS

Fittings (not to scale)

Code	Item	Quantity
M	Handle	2
P	Allen Key (4mm)	1
Q	Support for Hanging rail	2
R	Hinge for Door	6
S	Door Buffer	4
T	Hanging Rail	1
U	Anti-tilt Wall Strap	1

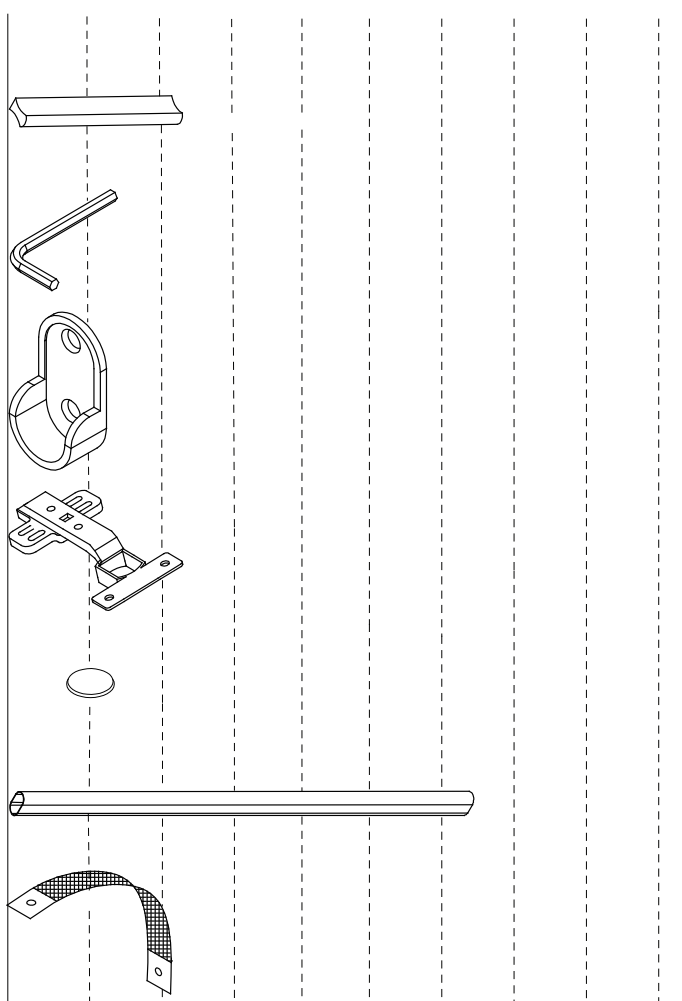

OTTAWA 2 DOOR WARDROBE ASSEMBLY INSTRUCTIONS

STEP 1

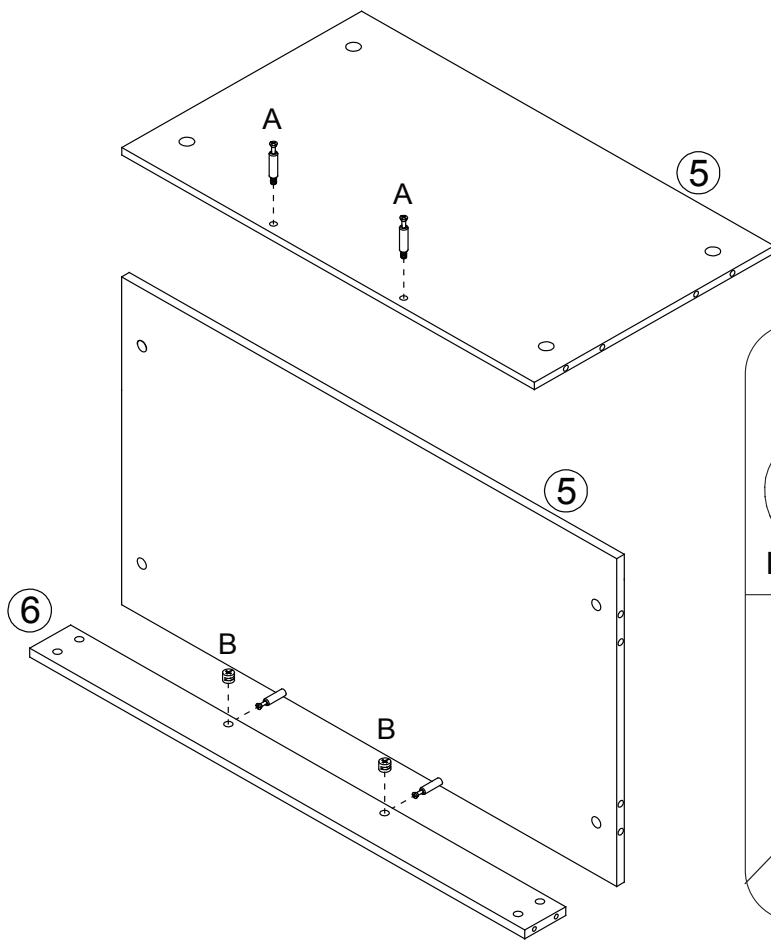

For this step:

Tools required

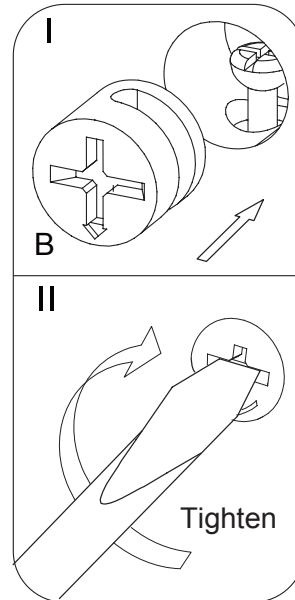
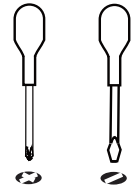

Fittings required

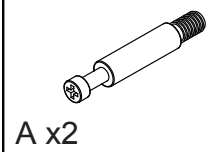

A x2



B x2

STEP 2

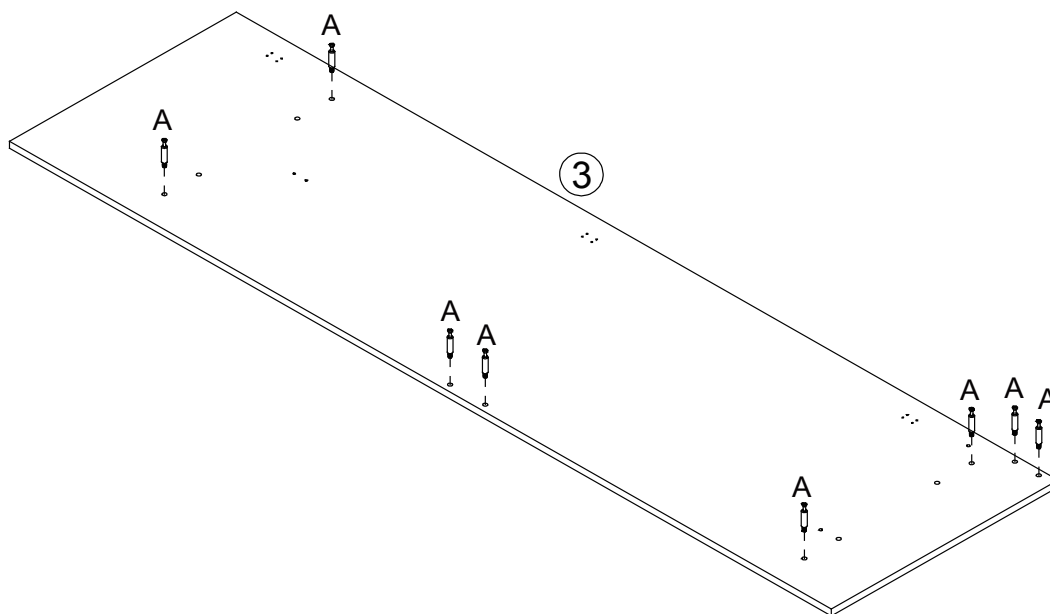

For this step:

Tools required



Fittings required

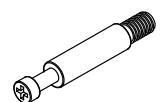

A x8

OTTAWA 2 DOOR WARDROBE ASSEMBLY INSTRUCTIONS

STEP 3

For this step:

Tools required

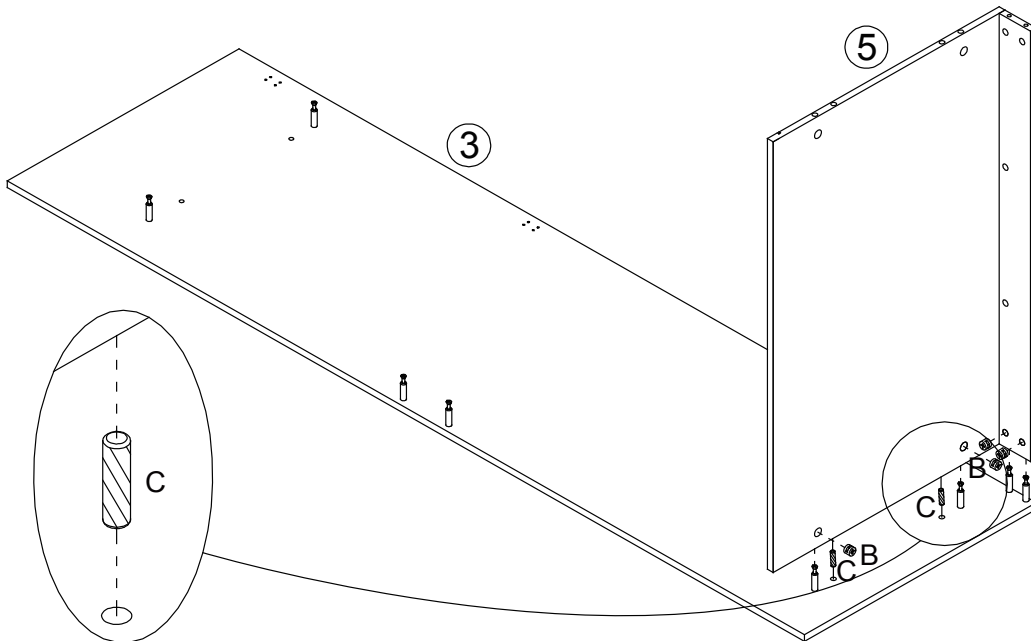
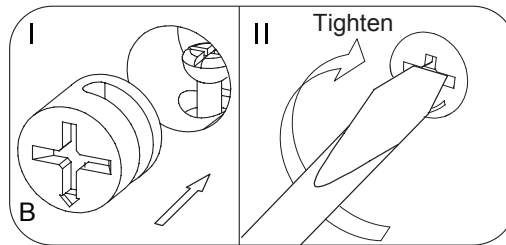

Fittings required



B x4

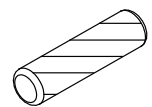

C x2

STEP 4

For this step:

Tools required

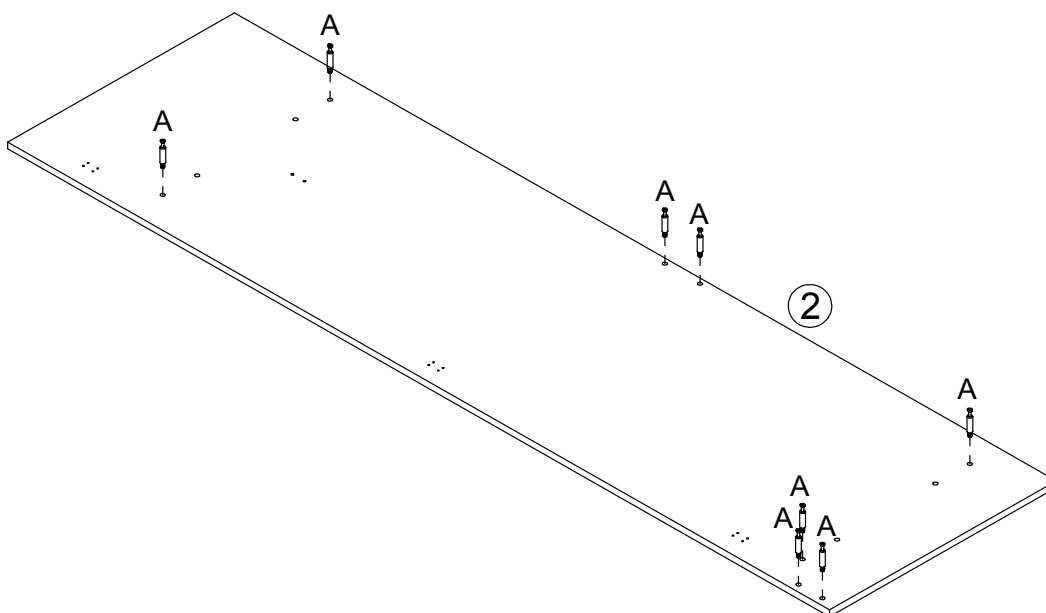

Fittings required

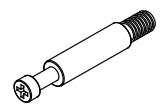

A x8

OTTAWA 2 DOOR WARDROBE ASSEMBLY INSTRUCTIONS

STEP 5

For this step:

Tools required



Fittings required



B x12

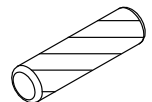

C x6

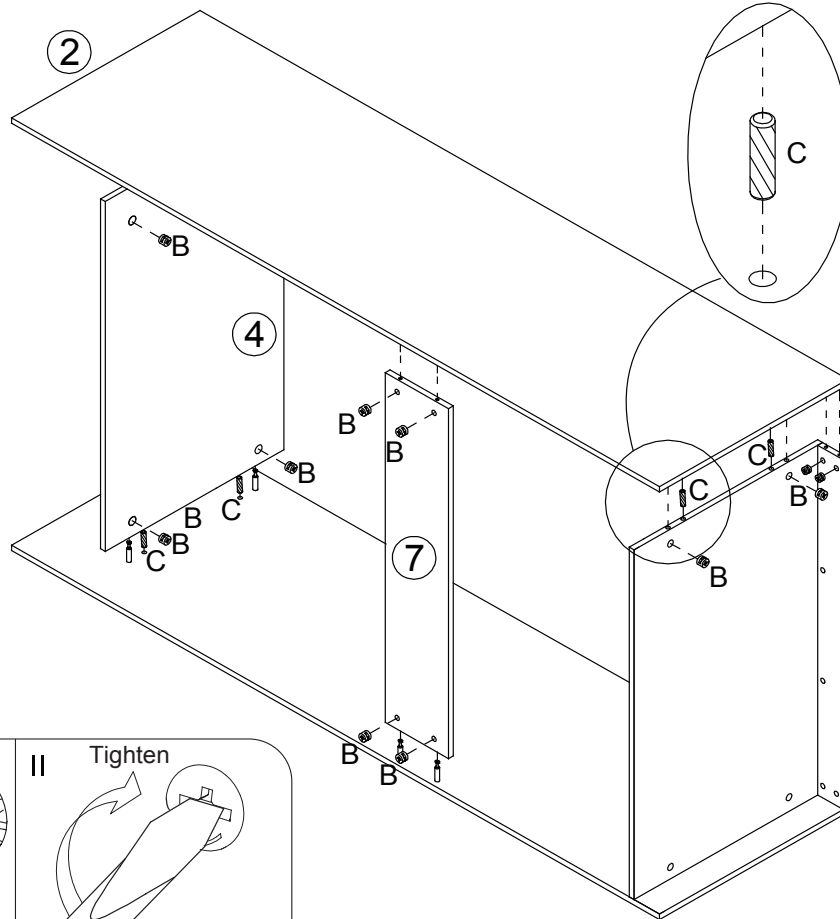
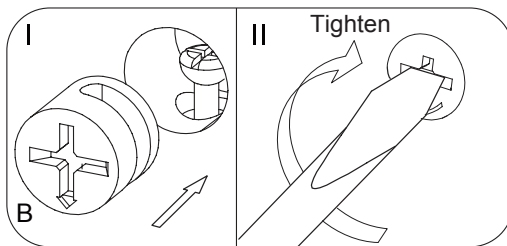

STEP 6

For this step:

Tools required

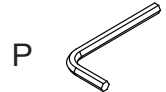

Fittings required

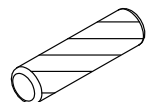

C x4

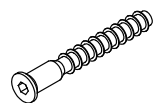

D x4

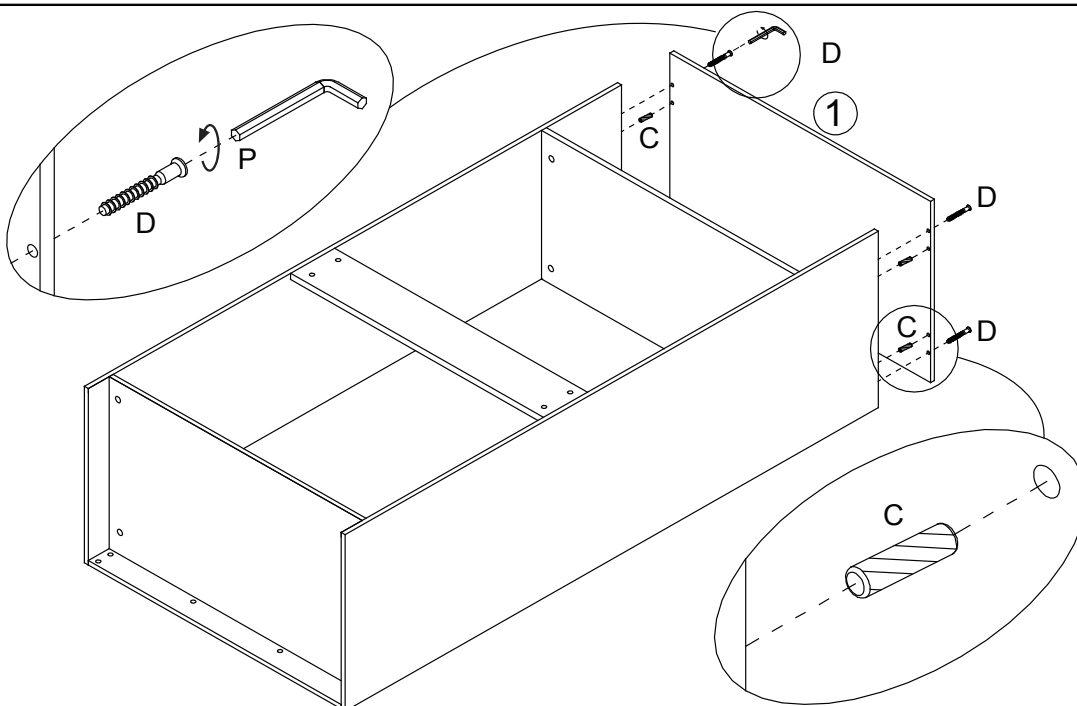

OTTAWA 2 DOOR WARDROBE ASSEMBLY INSTRUCTIONS

STEP 7

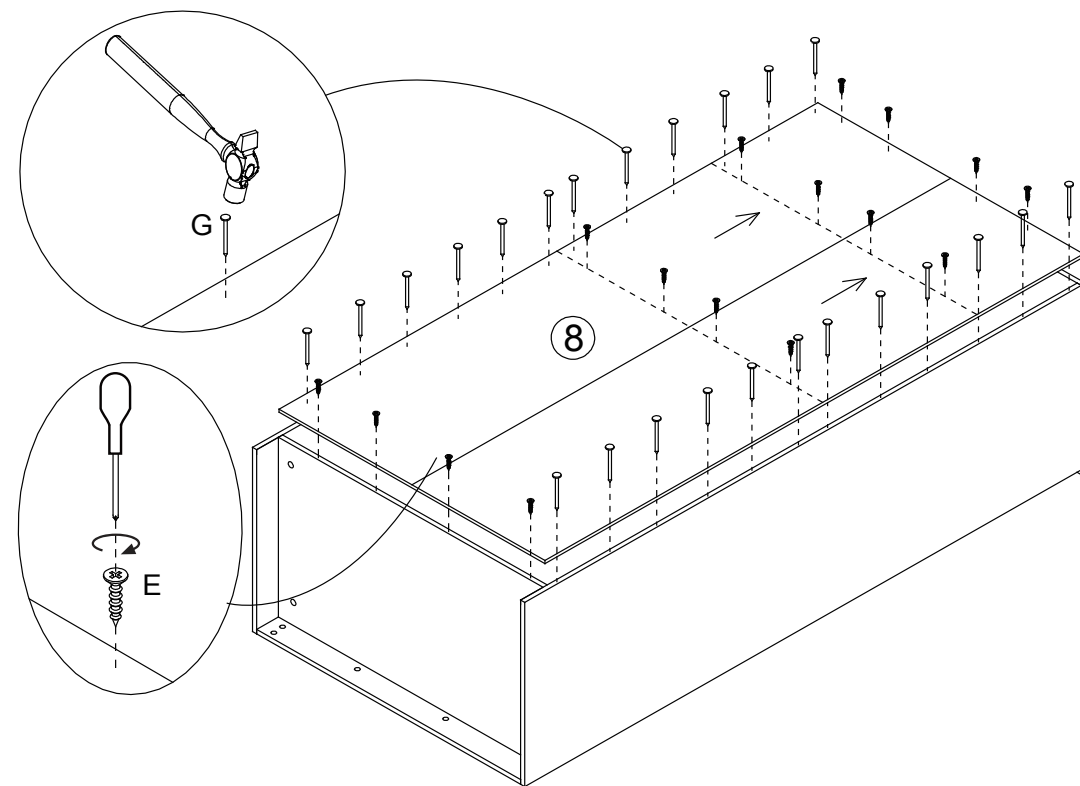

For this step:

Tools required

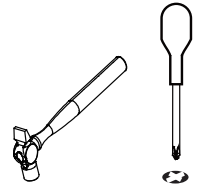

Fittings required

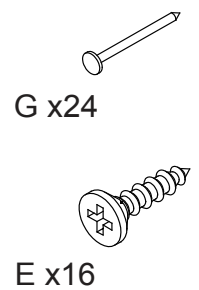

STEP 8

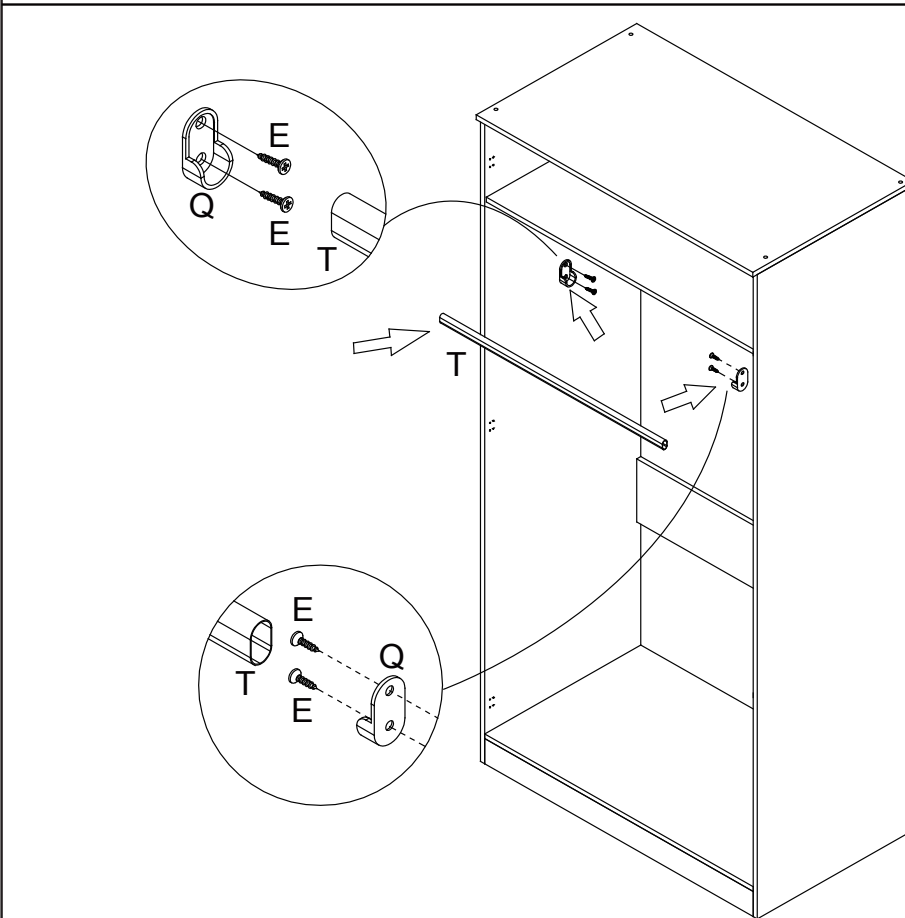

For this step:

Tools required

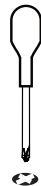

Fittings required

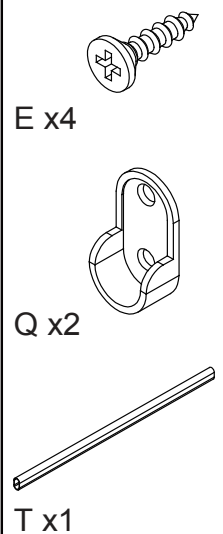

OTTAWA 2 DOOR WARDROBE ASSEMBLY INSTRUCTIONS

STEP 9

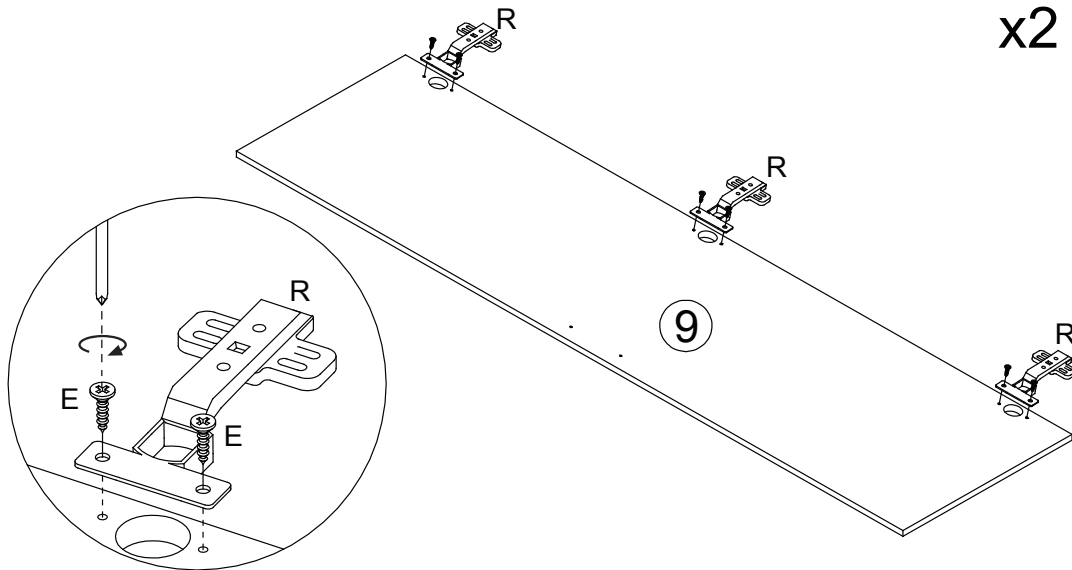

x2

For this step:
Tools required

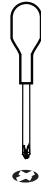

Fittings required

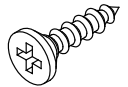

E x12

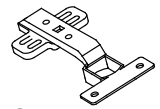

R x6

STEP 10

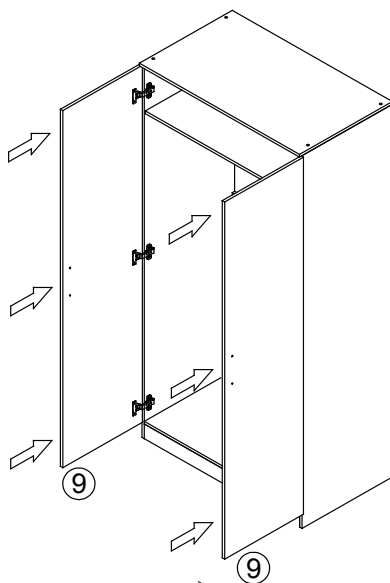

Fit Doors in Position

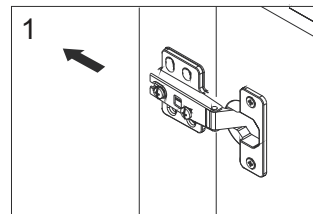

Fit x2 screws (E) in centre of long holes

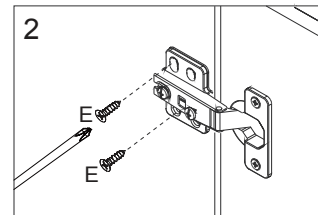

For this step:
Tools required

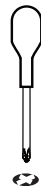

Fittings required

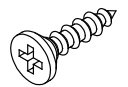

E x12

MAKE SURE WARDROBE IS LEVEL
IF DOORS NEED ADJUSTING, CAREFULLY FOLLOW THESE STEPS

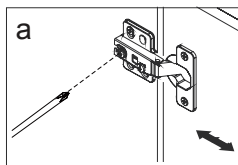

In or Out

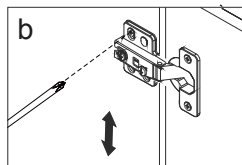

Up or Down

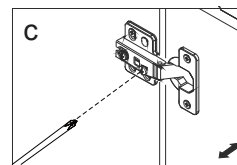

Left or right

Once both doors are level,
(adjusting if necessary as per
the steps a, b & c), fix x2 more
screws (E) in the round holes,
to lock each hinge plate (R)
in it's final position.

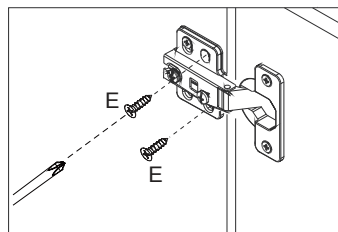

Fittings required

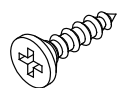

E x12

OTTAWA 2 DOOR WARDROBE ASSEMBLY INSTRUCTIONS

STEP 11

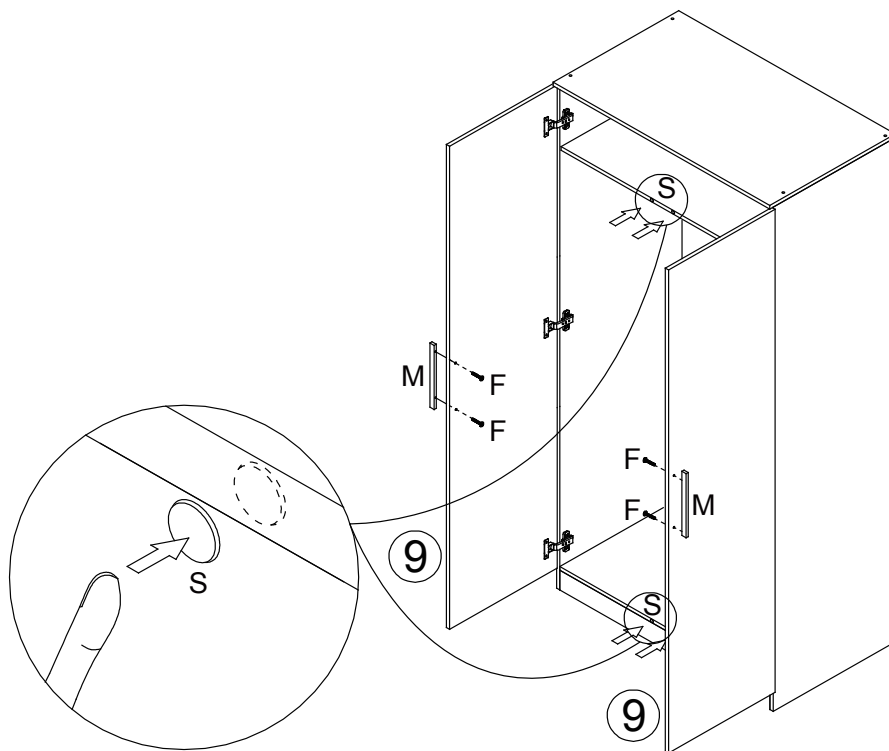

For this step:

Tools required



Fittings required

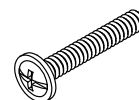

F x4

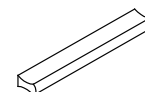

M x2



S x4

STEP 12

Note: We recommend the use of the wall strap provided (U) to avoid accidents and possible fatal injuries if the item falls over or tips over during use.

Warning: Always ensure the wall area to be drilled is free of electrical wires, water and gas pipes. We don't supply wall fixings as these must suit the wall type of your own home. If in doubt please consult a qualified tradesperson.

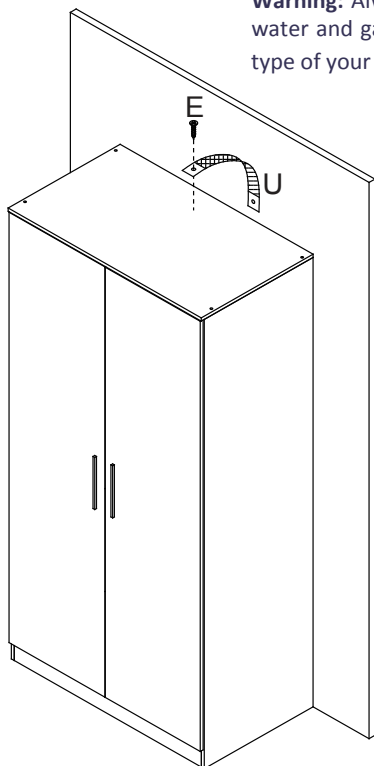

For this step:

Tools required



Fittings required

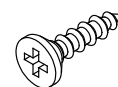

E x1

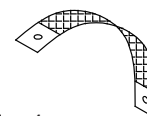

U x1

OTTAWA 2 DOOR WARDROBE ASSEMBLY INSTRUCTIONS

Assembly Completed

Your Ottawa 2 Door Wardrobe is now completely assembled.

Periodically check to ensure that the components are in their proper position, free from damage. Also, make sure the connectors are tight and secure.

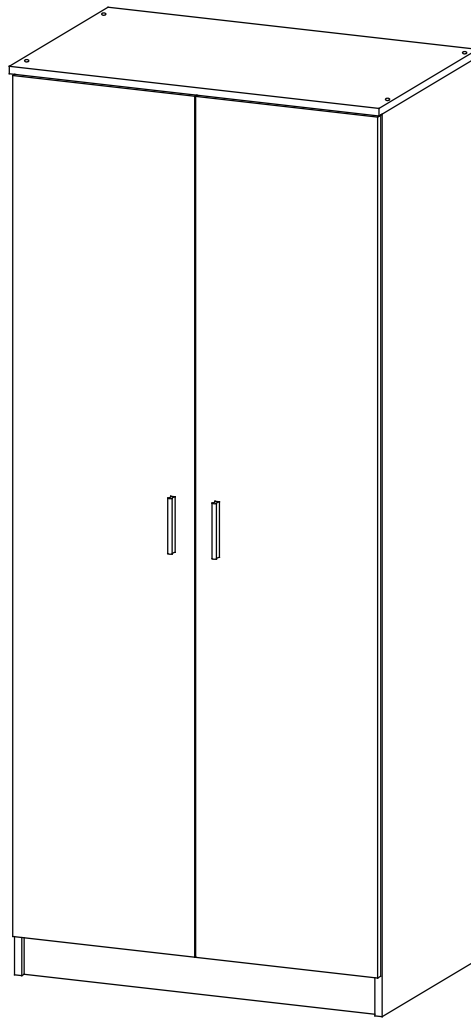

Keep instructions for future reference

